

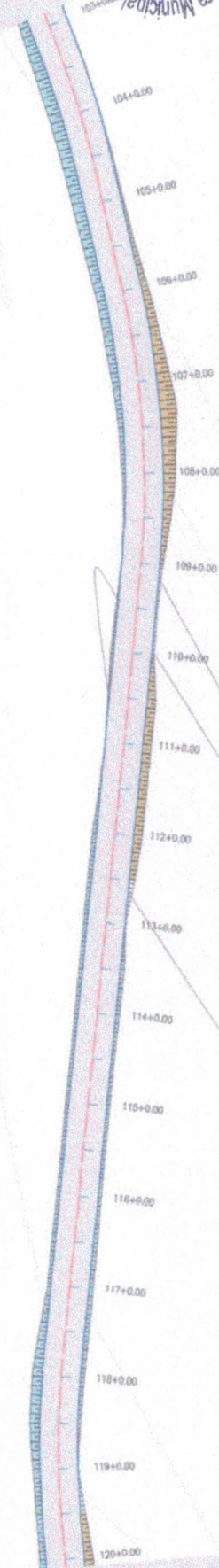

0 1000 2000

Cota vertical	Cota do terraplenagem	Cota do terreno	Estatos
0,000	100,000	99,473	100
0,002	100,177	99,500	103+00,00
0,003	100,400	99,507	103+10,00
0,005	100,501	99,548	103+17,00
0,005	100,503	99,550	104
0,016	100,537	99,581	104+10,00
0,034	100,595	99,671	105
0,069	100,673	99,773	105+10,00
0,074	100,640	99,784	106
0,140	100,402	99,532	106+10,00
0,202	100,330	99,763	107
0,276	100,228	99,601	107+10,00
0,345	100,130	99,500	108
0,472	100,009	99,360	108+10,00
0,503	100,034	99,531	109
0,253	100,009	99,716	109+10,00
0,093	99,984	99,901	110
-0,206	99,930	100,324	110+10,00
0,210	99,834	99,880	111
0,025	99,909	99,304	111+10,00
0,090	99,804	99,180	112
0,101	99,800	99,870	112+10,00
0,014	99,834	99,810	115
0,000	99,800	99,223	113+10,00
0,027	99,783	99,208	114
0,400	99,700	99,200	114+10,00
0,400	99,735	99,264	115
0,400	99,700	99,240	115+10,00
0,102	99,600	99,200	116
0,534	99,600	99,125	116+10,00
0,240	99,633	99,040	117
0,021	99,600	99,870	117+10,00
0,021	99,470	99,807	118
0,047	99,245	99,500	118+10,00
0,000	99,040	99,140	118
0,007	99,801	99,214	119+10,00
0,201	99,070	99,204	120
0,200	99,010	99,020	120



[Handwritten signature]

PREFETURA MUNICIPAL DE ACARUÁ
 PAVIMENTAÇÃO ASFALTICA DA ESTRADA QUE LIGA A LOCALIDADE DE
 ARARAUÁ À LOCALIDADE DE IMBÉ
 ESTAQUEAMENTO E PERFIL LONGITUDINAL
 PRN/DIAZ ALVARIZ, DSONA, E.T. D'AVILA
 ESCALA: 1:1.000
 7 / 27



Q 1000 2000

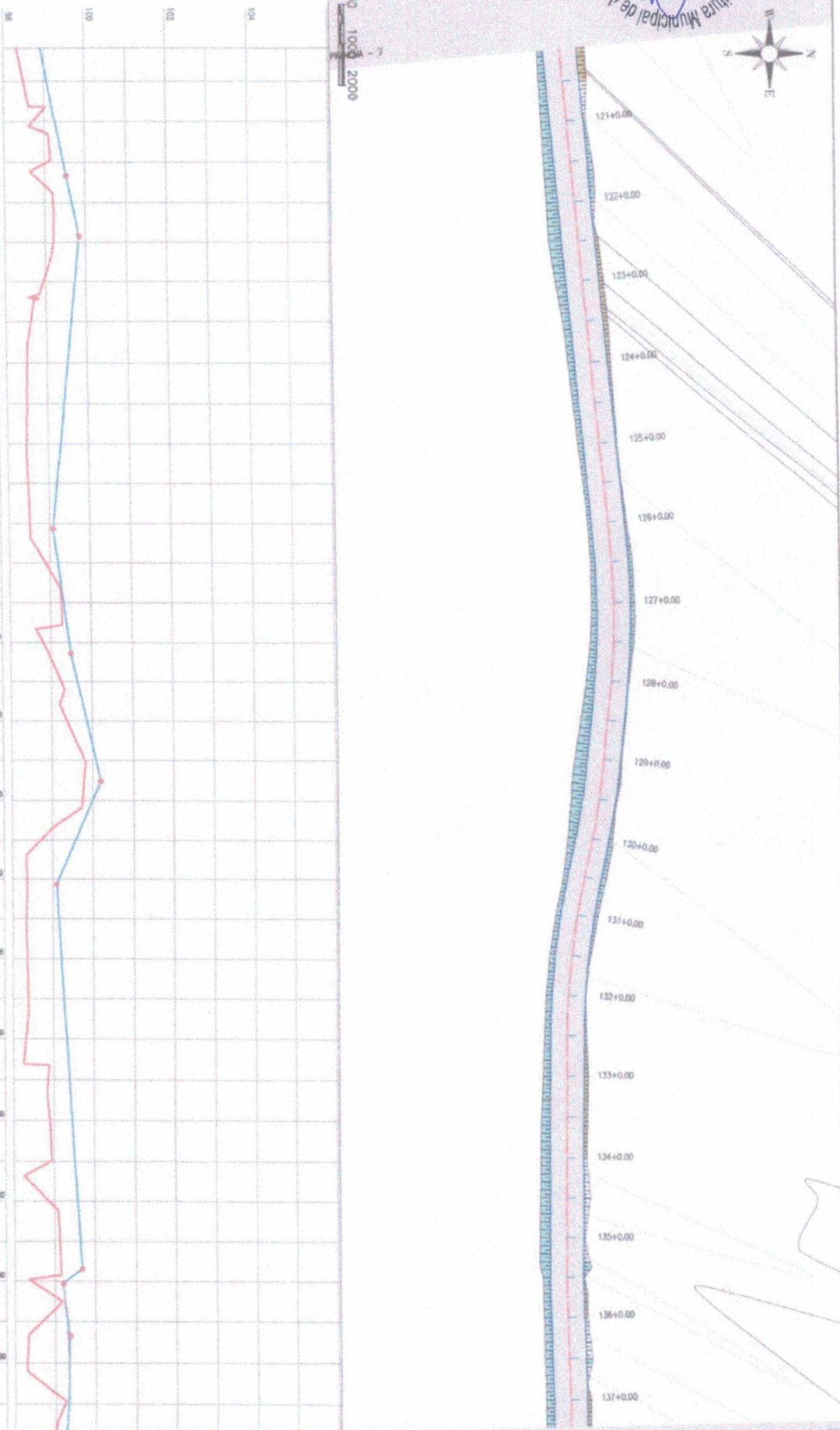

Cota vertical	Cota do topógráfico	Cota da base	Eixo
0,269	98,816	98,332	120
0,264	98,673	98,488	120+10,00
0,268	98,570	98,719	121
0,414	99,488	98,654	121+10,00
0,400	99,670	98,214	122
0,617	99,825	99,308	122+10,00
0,778	99,725	98,847	123
1,200	99,622	98,613	123+10,00
1,616	98,519	98,304	124
0,930	99,415	98,455	124+10,00
0,843	98,312	98,470	125
0,728	98,208	98,481	125+10,00
0,595	98,105	98,510	126
0,313	98,201	98,888	126+10,00
0,646	98,308	98,386	127
0,857	98,404	98,787	127+10,00
0,402	98,848	98,246	128
0,489	98,888	98,388	128+10,00
0,275	100,084	99,809	129
0,248	99,284	98,748	129+10,00
0,874	99,572	98,688	130
0,799	98,151	98,302	130+10,00
0,810	98,145	98,335	131
0,683	99,308	98,384	131+10,00
0,607	98,287	98,570	132
1,014	98,308	98,314	132+10,00
0,533	98,388	98,804	133
0,580	98,480	98,880	133+10,00
0,808	99,211	98,903	134
0,705	98,072	98,887	134+10,00
0,513	98,633	98,120	135
0,817	99,270	98,424	135+10,00
0,409	98,288	98,672	136
1,035	98,338	98,304	136+10,00
0,285	99,321	98,333	137
0,296	98,818	99,004	137

[Handwritten signature]

PROJETO ARQUITETÔNICO
 PAVIMENTAÇÃO ASFALTICA DA ESTRADA QUE LIGA A LOCALIDADE DE
 ARAUÁ A LOCALIDADE DE IMBÉ
 ESTACQUEAMENTO E PERFIL LONGITUDINAL
 PREFEITURA MUNICIPAL DE ACAUÁ
 ESCALA: 1:11000

8 / 27



1:10000

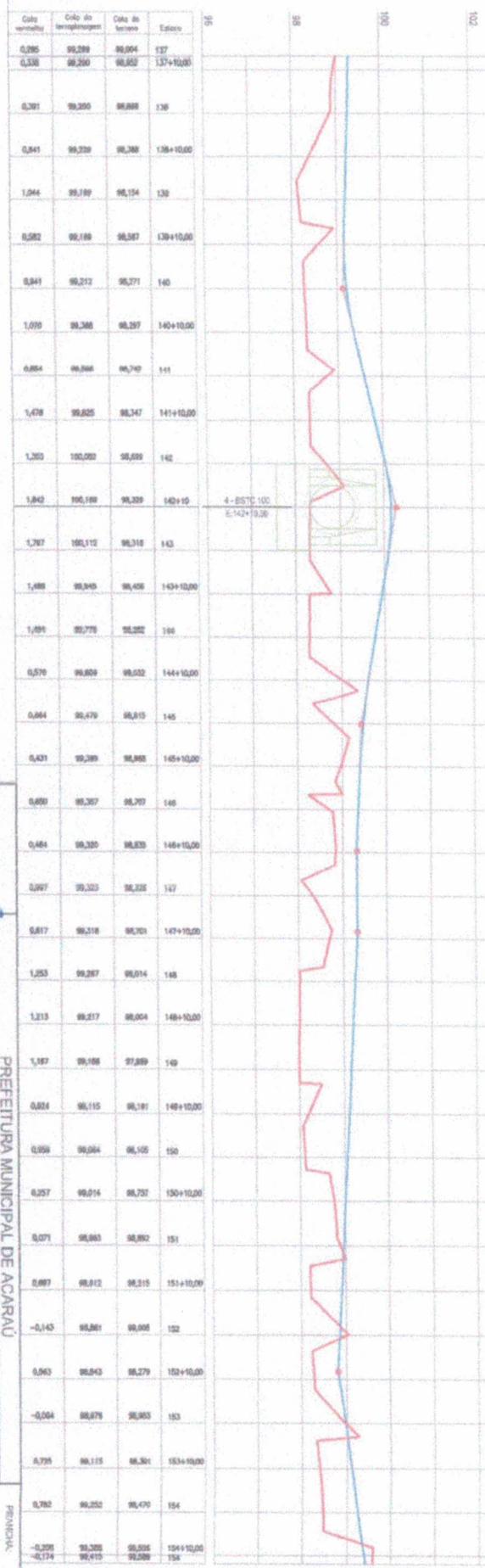
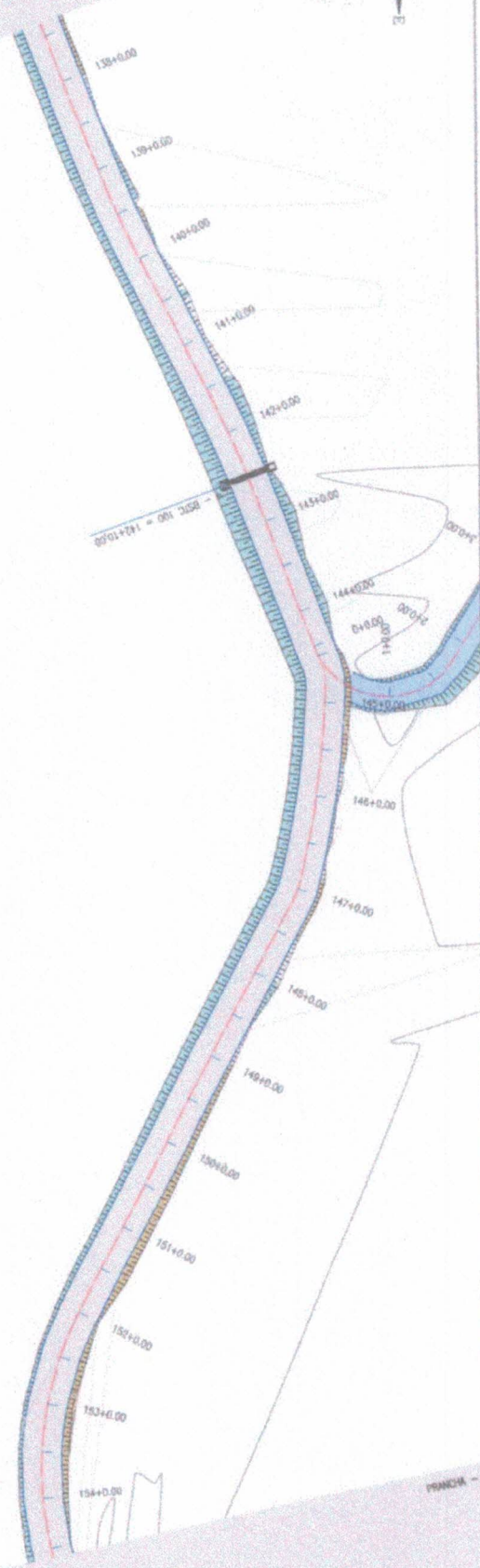

Cota vertical	Cota de tangentes	Cota de brechas	Estaca
0,285	99,289	99,004	137
0,338	99,290	99,053	137+10,00
0,391	99,300	99,088	138
0,441	99,329	99,208	138+10,00
1,044	99,189	99,154	139
0,282	99,189	99,267	139+10,00
0,841	99,212	99,271	140
1,019	99,266	99,297	140+10,00
0,854	99,364	99,749	141
1,478	99,825	99,347	141+10,00
1,203	100,002	99,659	142
1,842	100,169	99,339	142+10
1,787	100,112	99,318	143
1,488	99,345	99,406	143+10,00
1,091	99,778	99,282	144
0,579	99,809	99,552	144+10,00
0,664	99,479	99,815	145
0,421	99,289	99,888	145+10,00
0,690	99,267	99,707	146
0,464	99,320	99,830	146+10,00
0,297	99,323	99,832	147
0,617	99,218	99,701	147+10,00
1,253	99,287	99,014	148
1,213	99,217	99,004	148+10,00
1,187	99,166	97,899	149
0,034	99,115	99,181	149+10,00
0,959	99,064	99,105	150
0,257	99,014	99,737	150+10,00
0,071	99,063	99,892	151
0,687	99,012	99,315	151+10,00
-0,143	99,061	99,005	152
0,593	99,043	99,279	152+10,00
-0,004	99,076	99,063	153
0,735	99,115	99,301	153+10,00
0,782	99,252	99,470	154
-0,209	99,200	99,006	154+10,00
-0,174	99,415	99,006	154

PROJETO: PAVIMENTAÇÃO ASFALTICA DA ESTRADA QUE LIGA A LOCALIDADE DE ARANAU A LOCALIDADE DE LIMBÉ
 ESTAQUEAMENTO E PERFIL LONGITUDINAL
 ESCALA: 1:10000



0 1000 2000

Cota vertical	Cota do terreno	Cota do projeto	Estrada
-0,174	99,415	99,589	154
0,000	99,525	99,525	155+00,00
0,007	99,681	99,674	155+10,00
0,010	99,689	99,743	155+20,00
0,009	99,787	99,789	156
0,341	99,834	99,562	156+10,00
0,423	100,070	99,647	157
0,401	100,206	99,700	157+10,00
0,283	100,394	99,812	158
0,009	100,641	100,313	158+10,00
0,583	101,033	100,430	159
0,077	101,094	100,477	159+10,00
0,094	101,076	100,311	160
0,572	101,086	100,324	160+10,00
0,667	101,117	100,260	161
0,091	101,138	100,369	161+10,00
0,095	101,109	100,093	162
0,026	101,179	100,092	162+10,00
0,000	101,236	100,388	163
0,022	101,406	100,384	163+10,00
0,044	101,538	100,095	164
0,000	101,265	100,648	164+10,00
0,007	101,408	100,361	165
0,099	101,613	100,709	165+10,00
0,003	101,240	100,700	166
0,704	101,333	100,818	166+10,00
0,713	101,278	100,095	167
0,000	101,233	100,648	167+10,00
0,002	101,187	100,025	168
0,040	101,142	100,002	168+10,00
0,027	101,097	100,479	169
0,007	101,092	100,644	169+10,00
0,007	101,097	100,418	170
0,201	100,301	100,300	170+10,00
0,077	100,916	100,340	171
0,541	100,871	100,310	171+10,00
0,548	100,840	100,292	171

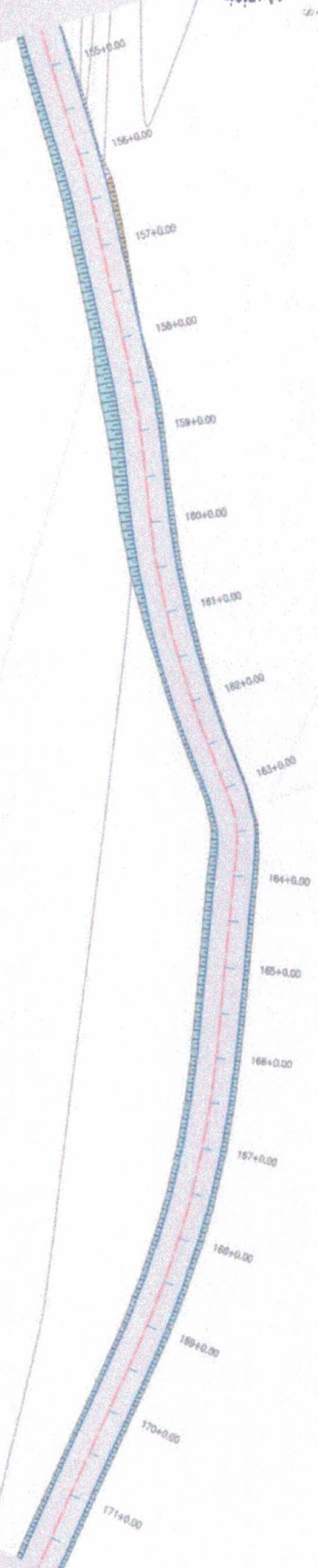

PROJETO
 ANEXO

PAVIMENTAÇÃO ASFALTICA DA ESTRADA QUE LIGA A LOCALIDADE DE ARANAU A LOCALIDADE DE IMIBE

ESTAOQUEAMENTO E PERFIL LONGITUDINAL

PREFEITURA MUNICIPAL DE ACARAJÁ

PROJETA: A. O. MARTINS, C. G. SILVA, R. L. D. SILVA

10 / 27

ESCALA: 1:10000

A

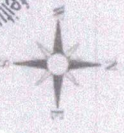

Q 1:000 2000

Cota vertical	Data do topógráfico	Data do terreno	Estatos
0,548	100,840	100,282	171
0,542	100,836	100,284	172+10,00
0,542	100,781	100,238	173+10,00
0,548	100,740	100,203	173+17,00
0,546	100,736	100,198	173
0,535	100,681	100,163	173+10,00
0,522	100,646	100,134	174
0,501	100,600	100,100	174+10,00
0,477	100,526	100,078	175
0,469	100,510	100,052	175+10,00
0,484	100,463	99,989	176
0,534	100,389	99,890	176+10,00
0,575	100,322	99,748	177
0,616	100,251	99,636	177+10,00
0,613	100,180	99,567	178
0,586	100,106	99,521	178+10,00
0,566	100,038	99,473	179
0,546	99,971	99,424	179+10,00
0,526	99,915	99,377	180
0,528	99,870	99,342	180+10,00
0,523	99,831	99,308	181
0,521	99,787	99,274	181+10,00
0,519	99,744	99,235	182
0,515	99,700	99,200	182+10,00
0,716	99,656	99,166	183
0,706	99,612	99,108	183+10,00
0,761	99,568	99,109	184
0,726	99,525	99,795	184+10,00
0,708	99,481	99,772	185
0,697	99,437	99,746	185+10,00
0,689	99,383	99,690	186
0,703	99,330	99,647	186+10,00
0,719	99,308	99,587	187
0,730	99,282	99,527	187+10,00
0,748	99,218	99,473	188
0,756	99,175	99,418	188+10,00
0,806	99,131	99,338	189
0,817	99,122	99,320	189

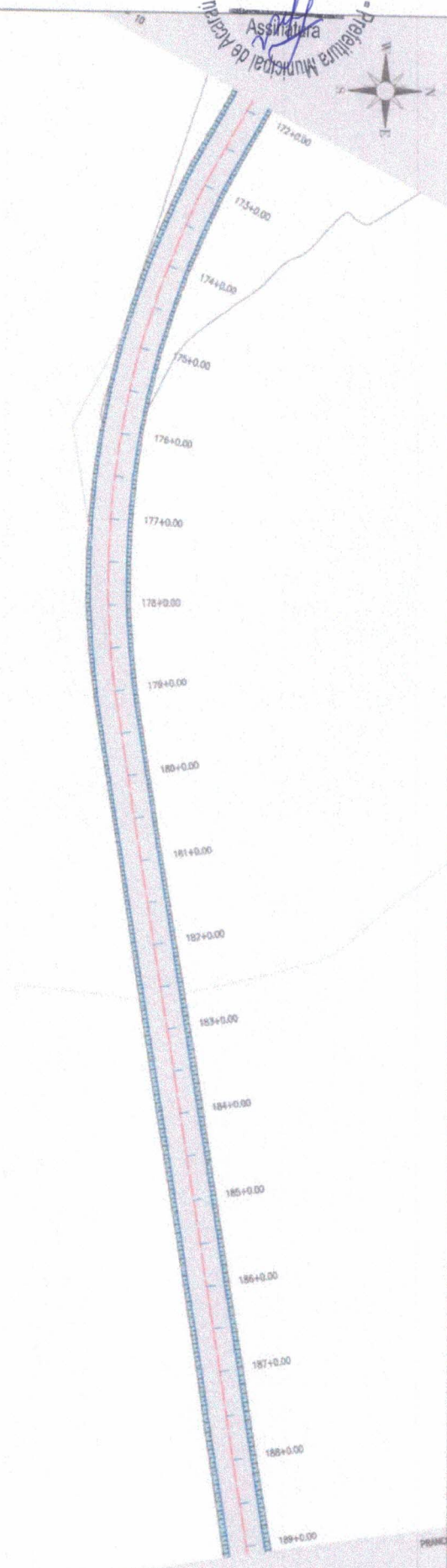

[Handwritten signature]

PROJETO: PAVIMENTAÇÃO ASFALTICA DA ESTRADA QUE LIGA A LOCALIDADE DE ARARAÚ À LOCALIDADE DE MIRÉ
 ESTADQUEAMENTO E PERFIL LONGITUDINAL
 ARARAÚ - PA, 01/04/2023 - 10:00h - 11:00h

PROJETADE: 11 / 27
 ESCALA: 1:1000

4



1:1000 2000

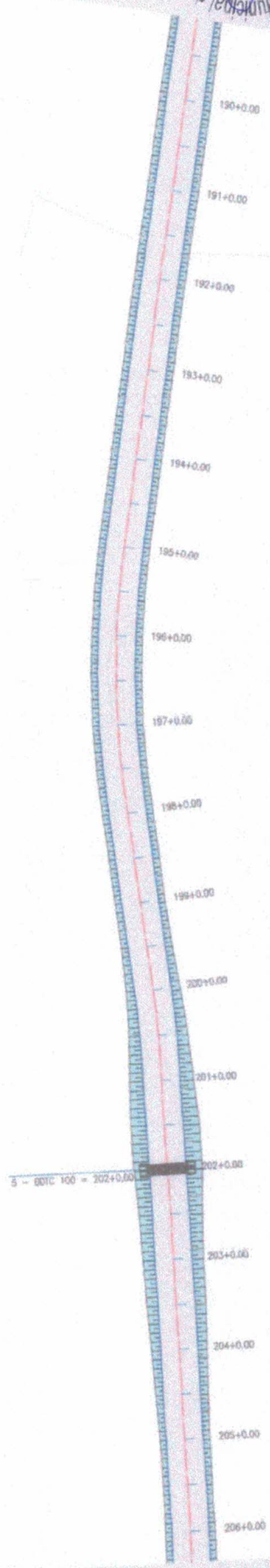
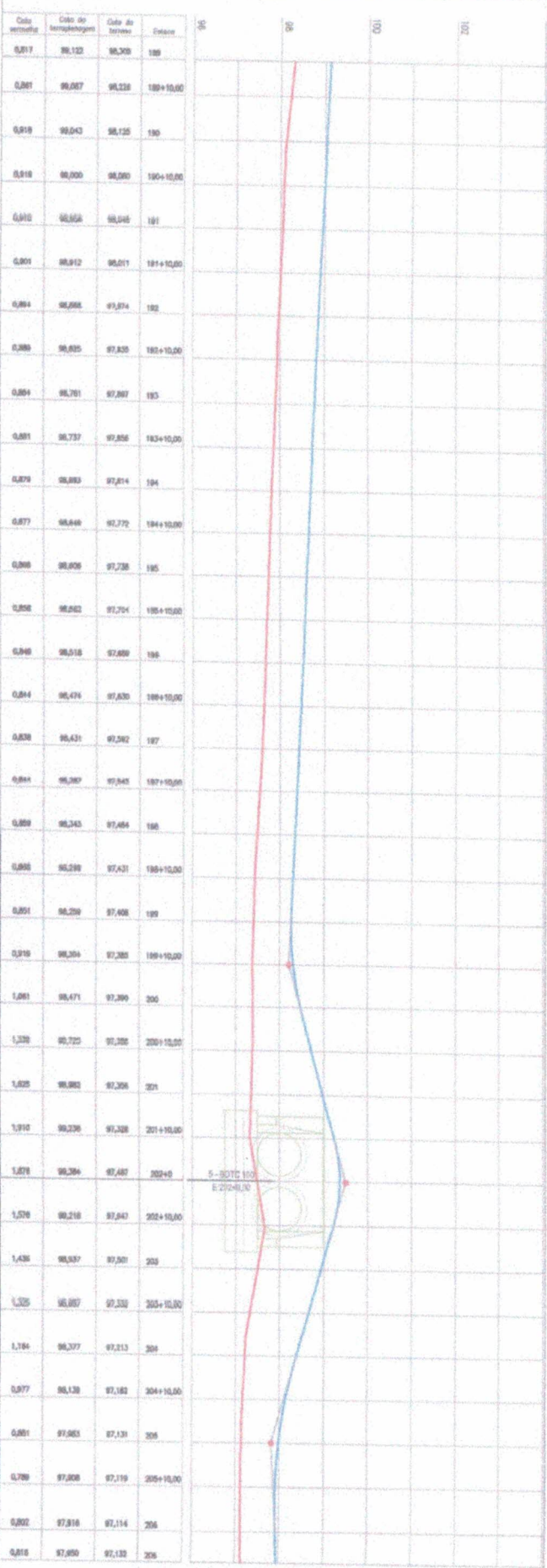

[Handwritten signature]

PROJETO: **PAVIMENTAÇÃO ASFÁLTICA DA ESTRADA QUE LIGA A LOCALIDADE DE ARANAU À LOCALIDADE DE IMBÉ**
 ESTADUEAMENTO E PERFIL LONGITUDINAL
 PRONOME: **12 / 27**
 ESCALA: **1/1000**



0 1000 2000

Cota anterior	Cota de terraplenagem	Cota de terreno	Estaca
0,818	97,850	97,132	206
0,820	97,892	97,140	206+10,00
0,848	98,014	97,188	207
0,871	98,094	97,193	207+10,00
0,895	98,113	97,218	208
0,918	98,182	97,244	208+10,00
0,947	98,211	97,284	209
0,960	98,280	97,270	209+10,00
1,033	98,310	97,277	210
1,063	98,389	97,286	210+10,00
1,082	98,408	97,348	211
1,081	98,457	97,380	211+10,00
1,087	98,507	97,449	212
1,090	98,550	97,516	212+10,00
1,099	98,606	97,583	213
1,098	98,654	97,642	213+10,00
1,094	98,703	97,680	214
0,989	98,753	97,734	214+10,00
1,094	98,802	97,787	215
1,018	98,851	97,838	215+10,00
1,020	98,900	97,874	216
1,033	98,948	97,917	216+10,00
1,030	98,996	97,969	217
1,027	99,048	98,021	217+10,00
1,017	99,097	98,080	218
1,000	99,148	98,148	218+10,00
0,983	99,192	98,213	219
0,944	99,240	98,301	219+10,00
0,888	99,294	98,380	220
0,850	99,343	98,483	220+10,00
0,781	99,392	98,641	221
0,692	99,441	98,789	221+10,00
0,647	99,491	98,844	222
0,630	99,522	98,873	222+10,00
0,618	99,544	98,885	223
0,630	99,560	98,838	223+10,00
0,613	99,588	98,800	223

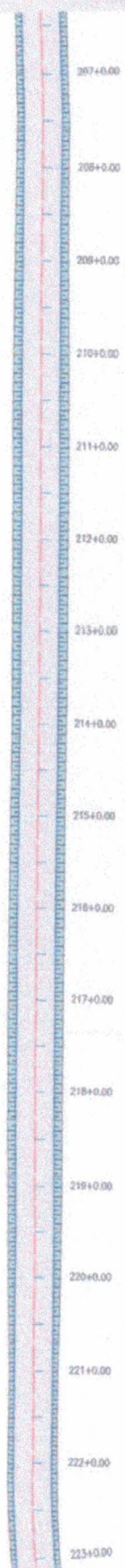

[Handwritten signature]

PROJETO: PAVIMENTAÇÃO ASFALTICA DA ESTRADA QUE LIGA A LOCALIDADE DE ARANAU A LOCALIDADE DE IMBÉ
 ESTAQUEAMENTO E PERFIL LONGITUDINAL
 EXECUÇÃO: FRANCISCO ALBERTO DE SOUZA FILHO
 ESCALA: 1/1000

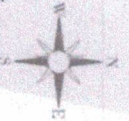

0 1000 2000

Cota vertical	Cota do topógráfico	Cota do terreno	Estatos
0,813	99,589	99,856	223
0,548	99,596	99,638	224+00,00
0,480	99,608	99,128	224+02,00
0,469	99,612	99,148	224+12,00
0,409	99,629	99,223	225
0,329	99,661	99,530	225+10,00
0,223	99,672	99,448	226
0,194	99,685	99,698	226+10,00
0,227	99,715	99,677	227
0,298	99,738	99,438	227+10,00
0,362	99,767	99,280	228
0,423	99,779	99,201	228+10,00
0,564	99,800	99,299	229
0,686	99,821	99,236	229+10,00
0,691	99,843	99,192	230
0,691	99,864	99,173	230+10,00
0,734	99,886	99,152	231
0,793	99,907	99,114	231+10,00
0,853	99,928	99,078	232
0,912	99,950	99,038	232+10,00
0,956	99,971	99,085	233
0,889	99,992	99,104	233+10,00
0,872	100,014	99,142	234
0,854	100,035	99,181	234+10,00
0,837	100,057	99,220	235
0,811	100,079	99,267	235+10,00
0,756	100,099	99,264	236
0,700	100,121	99,421	236+10,00
0,644	100,142	99,488	237
0,588	100,163	99,574	237+10,00
0,534	100,185	99,661	238
0,486	100,206	99,711	238+10,00
0,444	100,228	99,764	239
0,479	100,249	99,778	239+10,00
0,716	100,270	99,555	240
0,852	100,292	99,240	240+10,00
1,013	100,307	99,283	240

224+0,00
 225+0,00
 226+0,00
 227+0,00
 228+0,00
 229+0,00
 230+0,00
 231+0,00
 232+0,00
 233+0,00
 234+0,00
 235+0,00
 236+0,00
 237+0,00
 238+0,00
 239+0,00
 240+0,00

[Handwritten signature]

PROJETO
14 / 27
 ESCALA
 1:1000

PREFEITURA MUNICIPAL DE ACARAU
 PAV/ASR - AL 0142727_0200X - R1.DWG
 14/08/2011 10:00:00

A



0 1000 2000

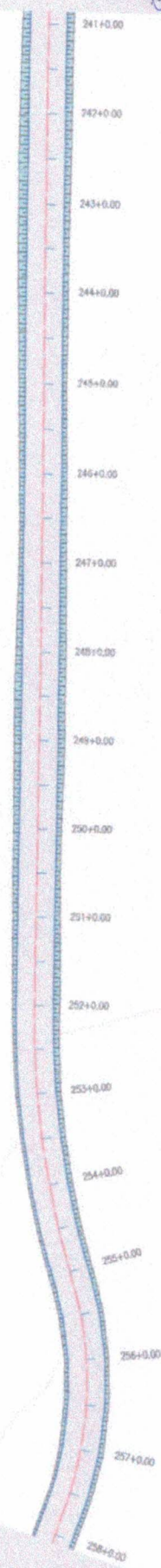
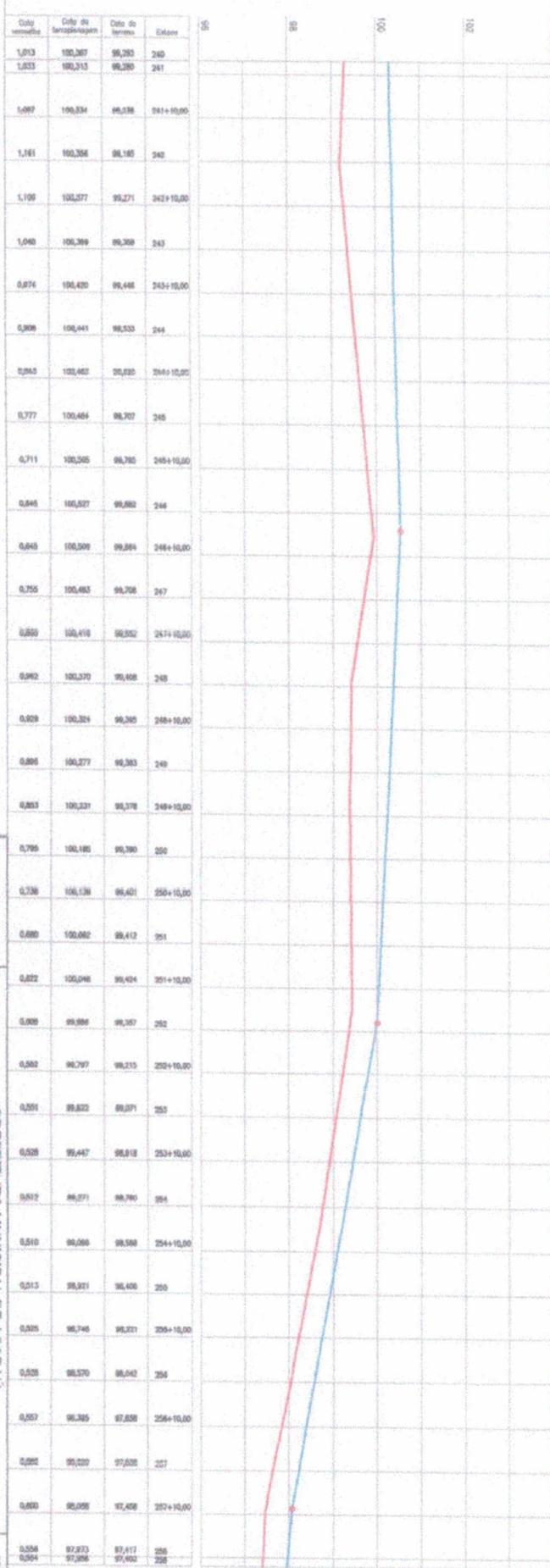

Cota vertical	Cota de tangentes	Cota do terreno	Estaca
1,013	100,267	99,283	240
1,033	100,313	99,280	241
1,067	100,334	99,338	242+10,00
1,161	100,354	99,185	243
1,195	100,377	99,271	242+10,00
1,040	100,389	99,309	243
0,074	100,420	99,448	243+10,00
0,309	100,441	99,533	244
0,243	100,462	99,620	244+10,00
0,777	100,484	99,707	245
0,711	100,505	99,785	245+10,00
0,845	100,527	99,882	246
0,643	100,509	99,884	246+10,00
0,755	100,493	99,708	247
0,850	100,416	99,552	247+10,00
0,902	100,370	99,408	248
0,929	100,324	99,345	248+10,00
0,896	100,277	99,383	249
0,803	100,231	99,378	249+10,00
0,795	100,185	99,390	250
0,736	100,136	99,421	250+10,00
0,690	100,082	99,412	251
0,622	100,048	99,404	251+10,00
0,609	99,988	99,387	252
0,582	99,797	99,215	252+10,00
0,551	99,822	99,071	253
0,528	99,447	98,918	253+10,00
0,612	98,971	98,790	254
0,510	99,089	99,588	254+10,00
0,513	98,921	98,406	255
0,505	98,740	98,221	255+10,00
0,528	98,370	98,042	256
0,557	98,385	97,838	256+10,00
0,582	98,020	97,628	257
0,650	98,098	97,428	257+10,00
0,556	97,973	97,417	258
0,564	97,896	97,402	258

[Handwritten signature]

PROJETO: PAVIMENTAÇÃO ASFÁLTICA DA ESTRADA QUE LIGA A LOCALIDADE DE ARANAÚ À LOCALIDADE DE IMBÉ
 ESTAQUEAMENTO E PERFIL LONGITUDINAL
 PREFEITURA MUNICIPAL DE ARACAJU
 PROJETO: AL. 01442/27.0004.01.010
 ESCALA: 1/10000



Q 1:000 2:000

Cota vertical	Cota de tempoagem	Cota de terreno	Eixo
0,554	97,956	97,402	258
0,560	97,889	97,201	258+10,00
0,580	97,805	97,120	256
0,594	97,721	97,125	258+10,00
0,599	97,681	97,062	260
0,600	97,602	97,002	260+10,00
0,600	97,563	97,063	261
0,601	97,584	97,063	261+10,00
0,599	97,701	97,101	262
0,600	97,758	97,140	262+10,00
0,598	97,861	97,263	263
0,596	97,890	97,264	263+10,00
0,593	98,119	97,528	264
0,590	98,248	97,850	264+10,00
0,587	98,378	97,791	265
0,584	98,507	97,603	265+10,00
0,602	98,623	98,021	266
0,601	98,600	98,061	266+10,00
0,585	98,611	98,008	267
0,603	98,580	97,989	267+10,00
0,578	98,558	97,831	268
0,583	98,457	97,876	268+10,00
0,588	98,406	97,818	269
0,604	98,302	97,751	269+10,00
0,613	98,384	97,691	270
0,608	98,253	97,608	270+10,00
0,644	98,201	97,507	271
0,661	98,150	97,409	271+10,00
0,645	98,099	97,404	272
0,626	98,048	97,421	272+10,00
0,610	97,996	97,387	273
0,563	97,845	97,302	273+10,00
0,575	97,858	97,394	274
0,538	97,698	97,470	274+10,00
0,487	98,000	97,601	275
0,448	98,090	97,268	275

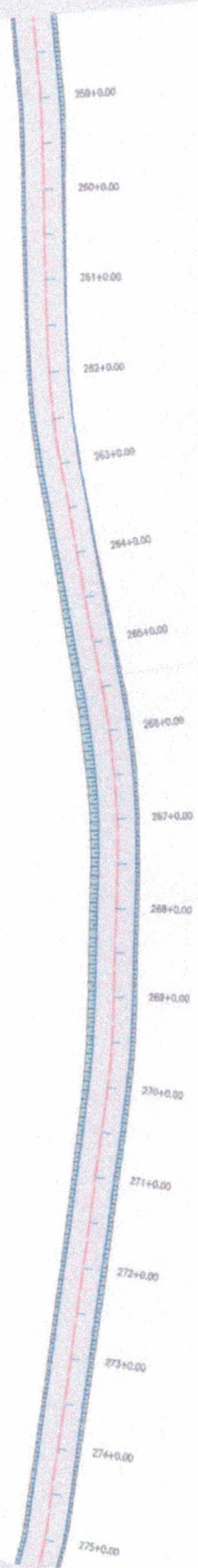

[Handwritten signature]

PREFEITURA MUNICIPAL DE ACARAÚ
 PAVIMENTAÇÃO ASFÁLTICA DA ESTRADA QUE LIGA A LOCALIDADE DE
 ARANAÚ À LOCALIDADE DE IMBÉ
 ESTAQUEAMENTO E PERFIL LONGITUDINAL
 PROJETO: ARCADIA
 PROJETO: AL. MARIZAL, GEOM. E T.D.M.G.
 16 / 27
 ESCALA: 1:1000



0 1000 2000

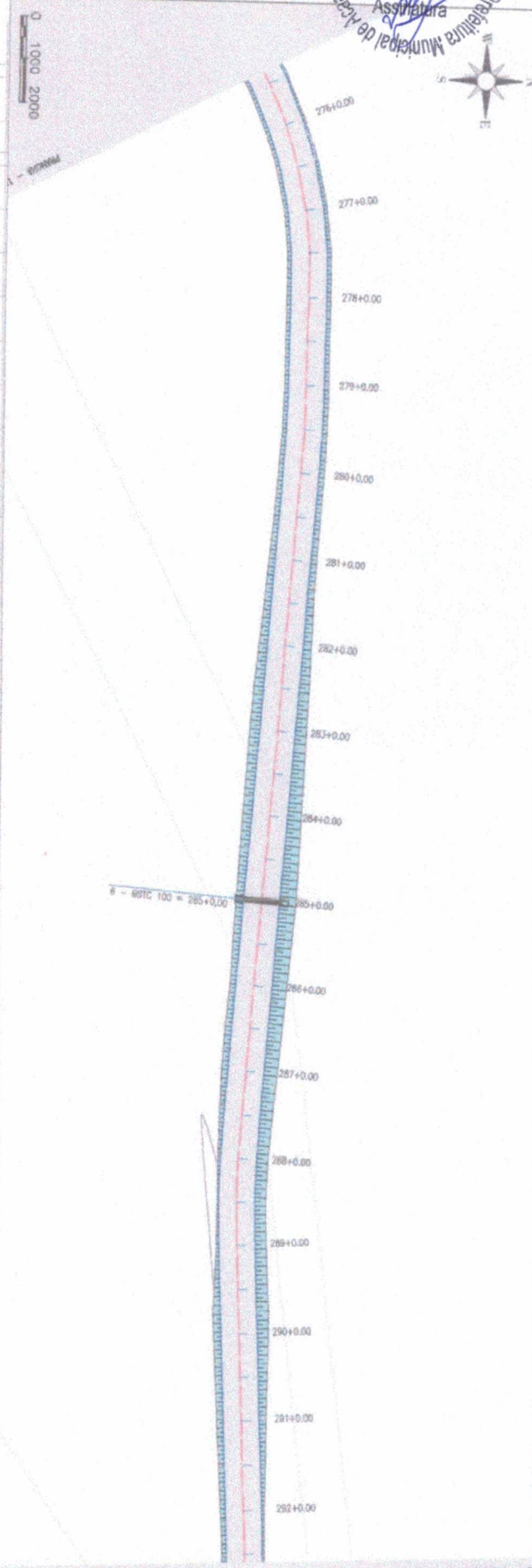
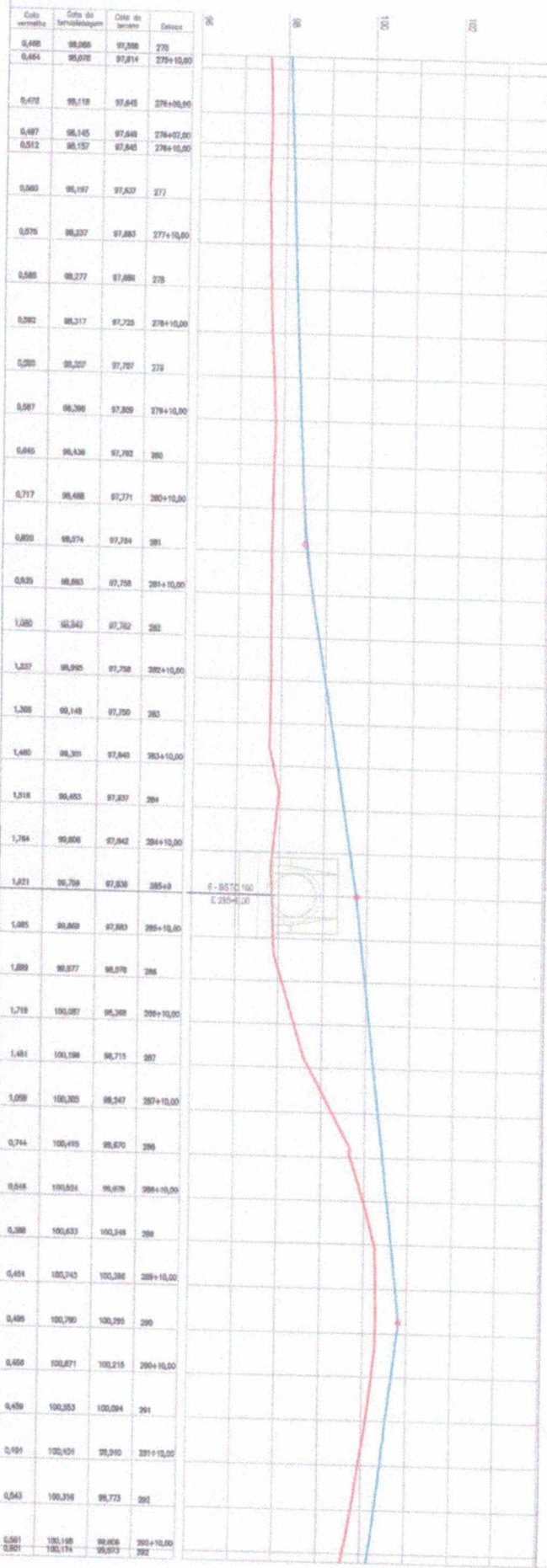

PROJETO
 ANEXO 1
 PAV/AS - AL. DUAZ 27 - CROM. 1:1000

PREFEITURA MUNICIPAL DE ACAUÃ
 PAVIMENTAÇÃO ASFALTICA DA ESTRADA QUE LIGA A LOCALIDADE DE
 ARAUÁ A LOCALIDADE DE IBIÉ
 ESTACQUEAMENTO E PERFIL LONGITUDINAL

PRONOME
17 / 27
 ESCALA:
 1:1000



PROJETO - 12
 1000 2000

Cota Vertical	Cota do Superfície	Cota do Terreno	Estaca
0,801	100,174	98,575	292
0,840	100,079	98,431	293
0,883	99,985	98,280	294+10,00
0,900	99,850	98,190	294
0,940	99,741	98,100	294+10,00
0,971	99,635	98,005	295
0,942	99,534	98,861	295+10,00
0,898	99,436	98,728	296
0,884	99,340	98,600	296+10,00
0,838	99,251	98,514	297
0,841	99,156	98,534	297+10,00
0,846	99,062	98,456	298
0,854	98,963	98,348	298+10,00
0,871	98,868	98,257	299
0,868	98,806	98,190	299+10,00
0,865	98,786	98,123	300
0,871	98,724	98,053	300+10,00
0,854	98,664	98,010	301
0,818	98,607	97,890	301+10,00
0,890	98,500	97,800	302
0,990	98,505	97,940	302+10,00
0,932	98,480	97,828	303
0,907	98,419	97,811	303+10,00
0,928	98,381	97,871	304
0,902	98,347	97,825	304+10,00
0,939	98,318	97,798	305
0,938	98,290	97,754	305+10,00
0,934	98,267	97,733	306
0,955	98,248	97,683	306+10,00
0,932	98,233	97,661	307
0,889	98,201	97,622	307+10,00
0,854	98,213	97,580	308
0,873	98,209	97,536	308+10,00
0,728	98,211	97,475	309
0,884	98,279	97,415	308+10,00
1,014	98,308	97,372	309

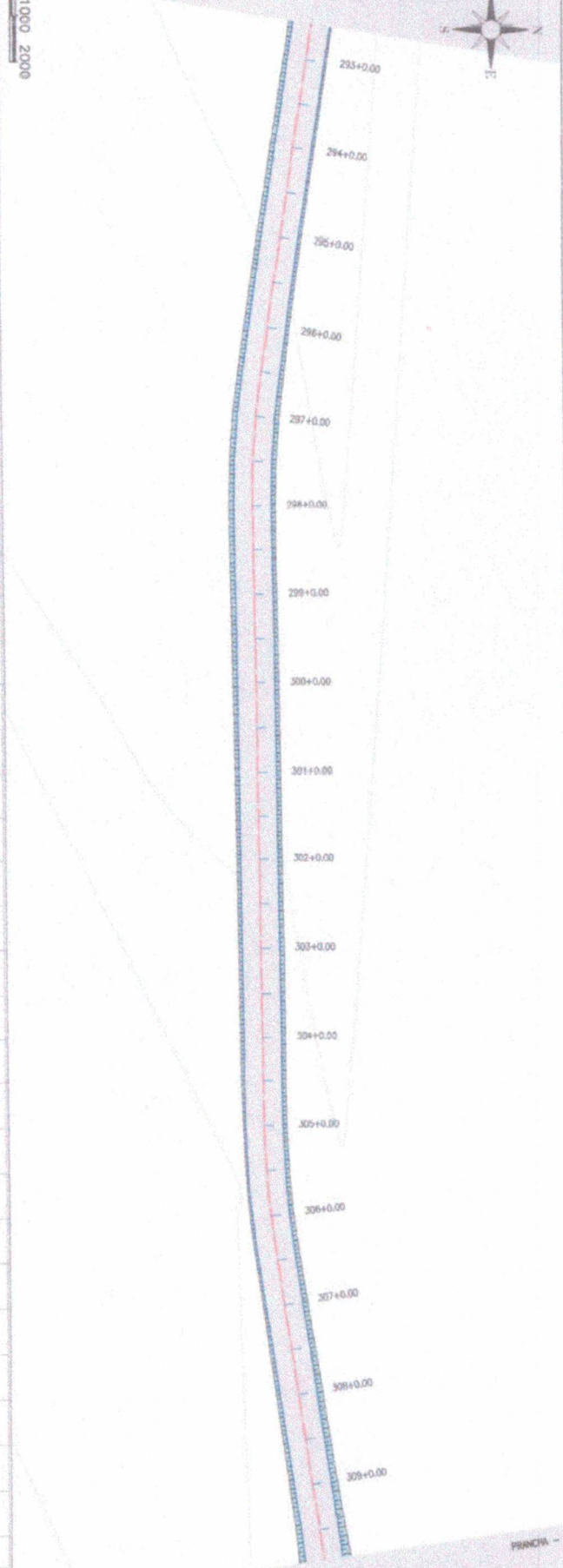

[Handwritten signature]

PROJETO
 PAVIMENTAÇÃO ASFÁLTICA DA ESTRADA QUE LIGA A LOCALIDADE DE
 ARAUANJÁ À LOCALIDADE DE IMBÉ
 ESTAQUEAMENTO E PERFIL LONGITUDINAL
 PREFEITURA MUNICIPAL DE ARACAJU
18 / 27
 ESCALA
 1:1000



0 1000 2000

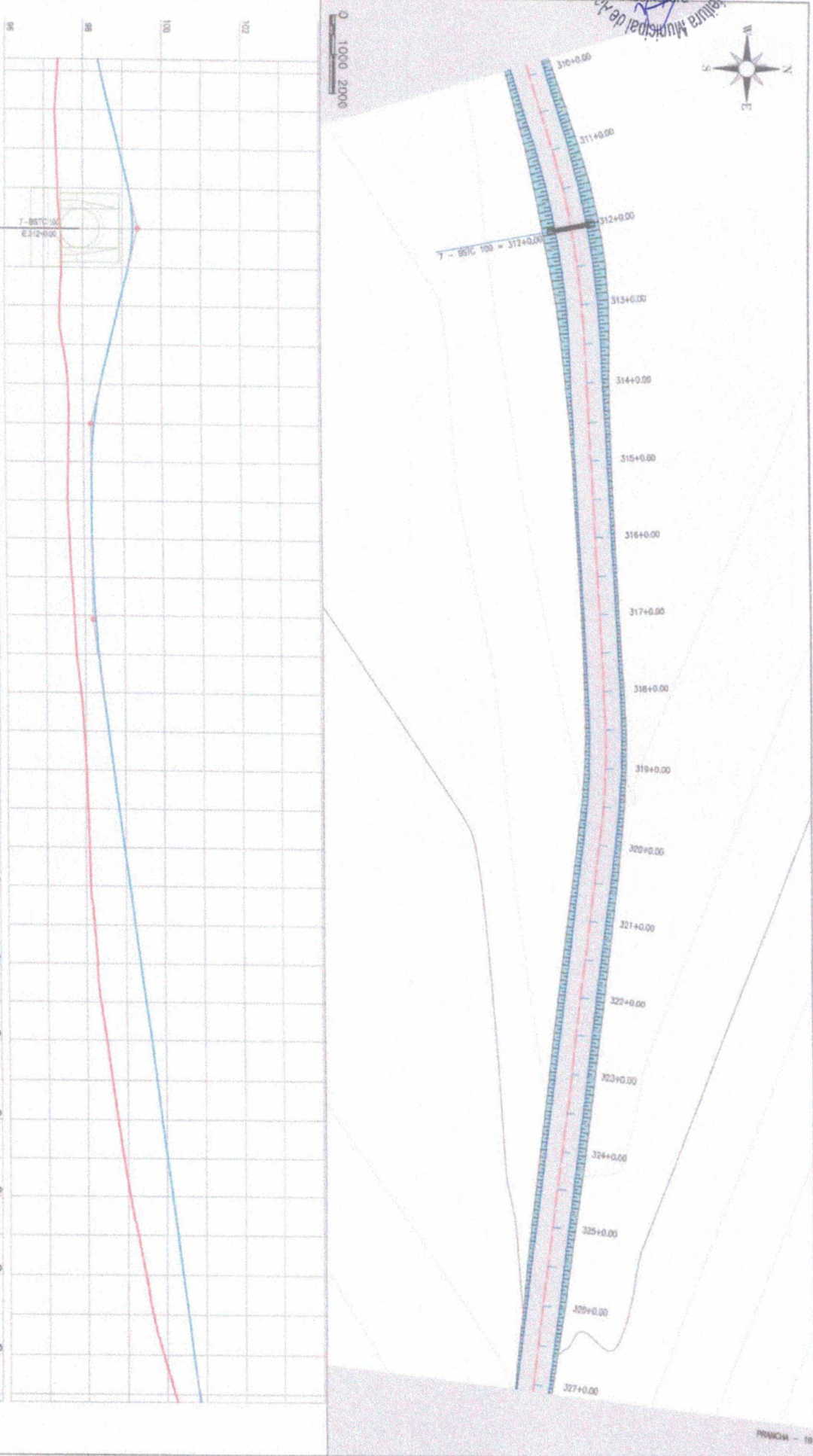

Cota de elevação	Cota de terraplenagem	Cota de terreno	Estaca
1,214	98,388	97,372	308
1,094	98,447	97,334	310
1,322	98,882	97,281	310+10,00
1,088	98,821	97,333	311
1,788	98,158	97,240	311+10,00
1,840	98,272	97,432	312+0
1,882	98,353	97,481	312+10,00
1,481	98,813	97,422	313
1,184	98,870	97,489	313+10,00
0,827	98,436	97,889	314
0,839	98,286	97,827	314+10,00
0,582	98,188	97,804	315
0,814	98,185	97,581	315+10,00
0,573	98,138	97,823	316
0,638	98,212	97,878	316+10,00
0,534	98,280	97,728	317
0,570	98,338	97,788	317+10,00
0,561	98,448	97,888	318
0,817	98,578	97,881	318+10,00
0,700	98,708	98,010	319
0,790	98,840	98,081	319+10,00
0,888	98,972	98,087	320
0,882	98,103	98,110	320+10,00
1,038	98,234	98,167	321
1,089	98,340	98,264	321+10,00
1,148	98,486	98,342	322
1,138	98,627	98,462	322+10,00
1,141	98,788	98,572	323
1,178	98,888	98,700	323+10,00
1,112	100,021	98,809	324
1,085	100,132	98,886	324+10,00
1,023	100,283	98,788	325
0,988	100,414	98,106	325+10,00
0,902	100,546	98,843	326
0,770	100,878	98,888	326+10,00
0,834	100,806	100,382	327
0,809	100,871	100,381	327

[Handwritten signature]

PROJETO: PAVIMENTAÇÃO ASFÁLTICA DA ESTRADA QUE LIGA A LOCALIDADE DE ARAVÁ À LOCALIDADE DE IMBÉ
 ESTAQUEAMENTO E PERFIL LONGITUDINAL
 PRONTO PARA APLICAÇÃO DE BARRAS
 ESCALA: 1:1000

Q. 01 - 19
 Escala: 1:1000, 2000

Cota vertical	Cota de Interseção	Cota do terreno	Elevação
0,899	100,871	100,361	327
0,905	101,100	100,513	327+10,00
0,971	101,500	100,838	328
0,980	101,807	101,348	329+10,00
0,994	102,295	101,711	329
0,901	102,630	102,028	329+10,00
0,902	102,633	102,231	330
0,910	103,037	102,419	330+10,00
0,912	103,281	102,880	331
0,905	103,500	102,884	331+10,00
0,907	103,771	103,184	332
0,909	103,910	103,290	332+10,00
0,917	103,879	103,362	333
0,941	103,994	103,446	333+10,00
0,903	104,000	103,443	334
0,999	104,018	103,417	334+10,00
0,901	103,808	103,377	335
0,907	103,866	103,389	335+10,00
0,994	103,790	103,181	336
0,910	103,790	103,111	336+10,00
0,939	103,730	103,081	337
0,900	103,741	103,130	337+10,00
0,902	103,704	103,301	338
0,905	103,910	103,310	338+10,00
0,900	104,040	103,430	339
0,913	104,170	103,507	339+10,00
0,919	104,300	103,680	340
0,923	104,263	103,770	340+10,00
0,746	104,444	103,899	341
0,899	104,488	103,889	341+10,00
1,005	104,547	103,942	342
1,117	104,588	103,481	342+10,00
1,160	104,800	103,690	343
1,159	104,701	103,948	343+10,00
1,142	104,753	103,810	344
1,138	104,788	103,862	344

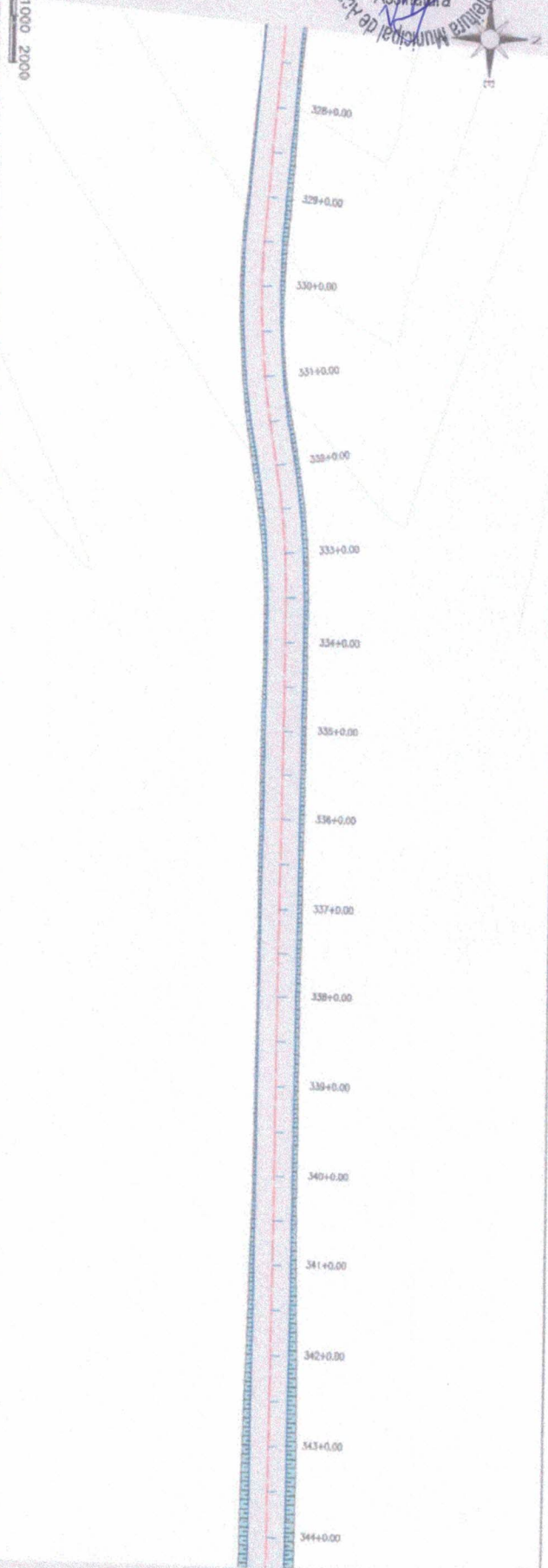

PROJETO
 ANEXO
 PAV/AS - AL 01/27/21 - 250CM, 81, DIV 0
 PREFEITURA MUNICIPAL DE ACARAÚ
 PAVIMENTAÇÃO ASFALTICA DA ESTRADA QUE LIGA A LOCALIDADE DE
 ARAVANÁ A LOCALIDADE DE IMBÉ
 ESTAQUEAMENTO E PERFIL LONGITUDINAL
 20 / 27
 ESCALA: 1:1000



0 20
 1:2000 2000

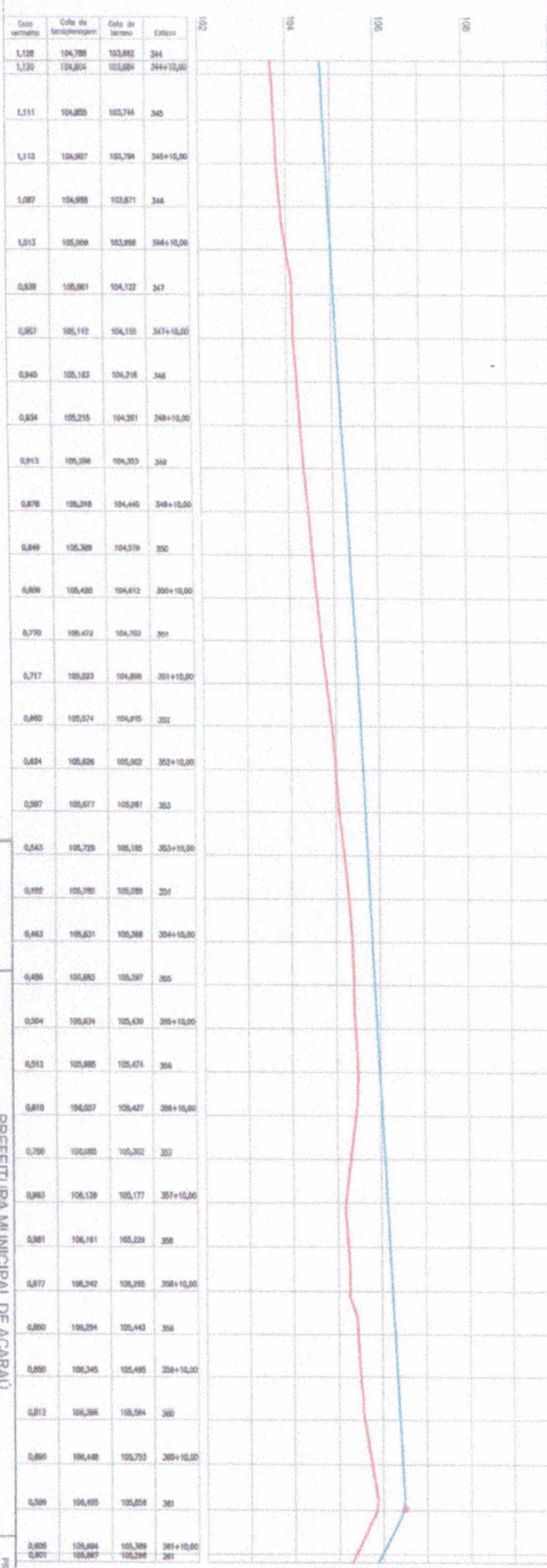

Cota vertical	Cota da topografia	Cota de terreno	Estaca
1,128	104,788	103,882	344
1,129	104,804	103,894	344+10,00
1,111	104,820	103,744	345
1,113	104,807	103,794	345+10,00
1,087	104,808	103,871	346
1,013	105,008	103,898	346+10,00
0,938	105,081	104,122	347
0,957	105,112	104,155	347+10,00
0,940	105,183	104,218	348
0,854	105,215	104,281	348+10,00
0,913	105,286	104,353	349
0,878	105,318	104,440	349+10,00
0,848	105,389	104,519	350
0,809	105,430	104,612	350+10,00
0,770	105,472	104,703	351
0,717	105,523	104,806	351+10,00
0,690	105,574	104,915	352
0,624	105,626	105,002	352+10,00
0,587	105,677	105,081	353
0,543	105,728	105,185	353+10,00
0,505	105,780	105,288	354
0,463	105,831	105,388	354+10,00
0,426	105,883	105,507	355
0,394	105,934	105,630	356+10,00
0,313	105,985	105,674	356
0,810	106,037	105,827	356+10,00
0,790	106,078	105,903	357
0,843	106,130	105,777	357+10,00
0,861	106,181	105,228	358
0,877	106,242	105,285	358+10,00
0,880	106,294	105,443	359
0,850	106,345	105,495	359+10,00
0,812	106,396	105,584	360
0,860	106,448	105,703	360+10,00
0,588	106,499	105,858	361
0,805	106,551	105,969	361+10,00
0,841	106,602	105,884	362

[Handwritten signature]

PROJETO: PAVIMENTAÇÃO ASFÁLTICA DA ESTRADA QUE LIGA A LOCALIDADE DE ARAUÁ À LOCALIDADE DE IMBÉ
 ESTAQUEAMENTO E PERFIL LONGITUDINAL
 PREFEITURA MUNICIPAL DE ACARAU
 21 / 27
 ESCALA: 1:1000

A



0
 0000 2000
 Escala - 1:21

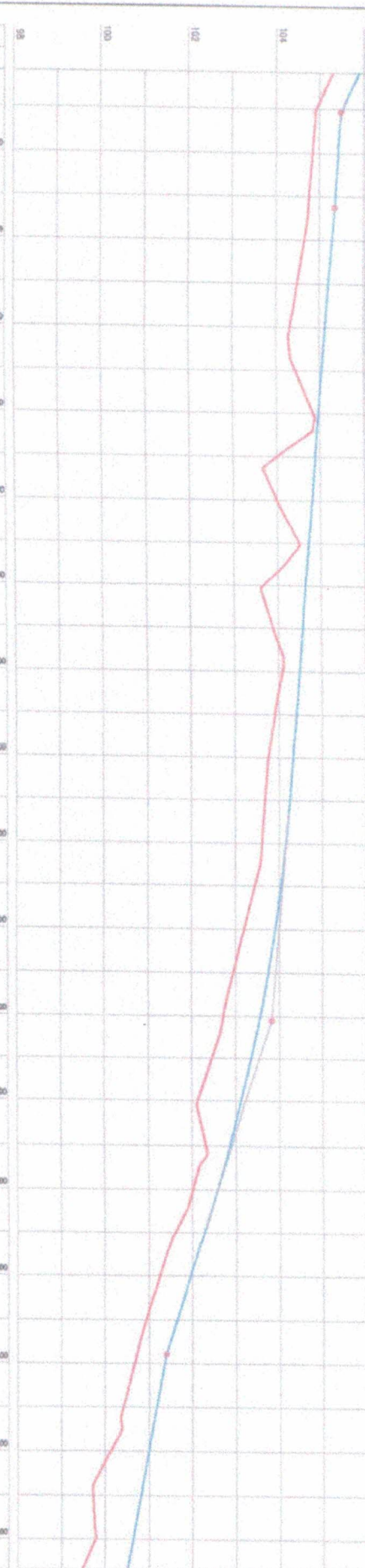

Cota vertical	Cota do topógráfico	Cota do terreno	Distância
0,801	105,897	105,298	361
0,804	105,536	104,922	362
0,592	105,431	104,538	363+10,00
0,588	105,361	104,782	363
0,838	105,386	104,647	363+10,00
0,725	105,200	104,460	364
0,812	105,125	104,213	364+10,20
0,812	105,044	104,432	365
0,121	104,862	104,842	365+10,00
0,895	104,862	105,960	366
0,812	104,802	105,980	366+10,20
0,227	104,721	104,484	367
0,882	104,640	103,808	367+10,00
0,884	104,558	103,825	368
0,383	104,476	104,688	368+10,00
0,495	104,388	103,963	369
0,583	104,277	103,754	369+10,00
0,582	104,237	103,874	370
0,547	104,152	103,883	370+10,00
0,588	104,038	103,441	371
0,712	103,905	103,183	371+10,00
0,801	103,746	102,845	372
0,849	103,582	102,722	372+10,00
0,897	103,504	103,486	373
0,385	103,121	102,740	373+10,00
0,543	102,884	102,317	374
0,584	102,582	102,518	374+10,00
0,678	102,278	101,888	375
0,710	101,881	101,258	375+10,00
0,698	101,646	100,848	376
0,886	101,388	100,872	376+10,00
0,738	101,178	100,418	377
0,888	100,997	100,128	377+10,00
1,088	100,817	99,728	378
0,857	100,637	99,778	378+10,00
1,031	100,511	99,478	378

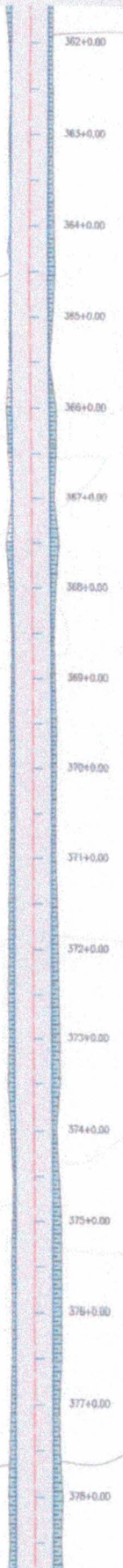

[Handwritten signature]

PROJETO: PAVIMENTAÇÃO ASFÁLTICA DA ESTRADA QUE LIGA A LOCALIDADE DE ARANAÚ À LOCALIDADE DE IMBÉ
 ESTAQUEAMENTO E PERFIL LONGITUDINAL
 PREFEITURA MUNICIPAL DE ACARAUÁ
 PROJETO: PAULO JOSÉ DE SOUZA JUNIOR
 ESCALA: 1:10000

A



0 1:500 2000

Cota vertical	Cota de terraplenagem	Cota de laje	Cota
1,031	100,511	98,479	378
1,110	100,457	98,347	379
1,124	100,278	98,152	379+10,00
1,234	100,098	98,062	380
1,045	99,818	98,870	380+10,00
1,333	99,738	98,802	381
1,500	99,558	98,548	381+10,00
0,983	98,375	96,382	382
0,992	98,195	96,212	382+10,00
0,811	98,014	96,033	383
0,743	98,834	98,091	383+10,00
0,680	98,654	97,984	384
0,648	98,474	97,828	384+10,00
0,625	98,313	97,667	385
0,648	98,178	97,536	385+10,00
0,622	98,074	97,432	386
0,619	97,889	97,279	386+10,00
0,584	97,882	97,288	387
0,581	97,630	97,374	387+10,00
0,588	97,946	97,378	388
0,672	97,888	97,286	388+10,00
0,599	97,890	97,289	389
0,628	98,012	97,384	389+10,00
0,687	98,034	97,387	390
0,731	98,086	97,218	390+10,00
0,807	98,078	97,271	391
0,882	98,105	97,238	391+10,00
0,883	98,122	97,235	392
0,924	98,144	97,219	392+10,00
0,987	98,197	97,289	393
1,148	98,345	97,199	393+10,00
1,338	98,524	97,188	394
1,528	98,706	97,178	394+10,00
1,714	98,882	97,167	395
1,882	99,023	97,170	395+10,00
1,998	99,188	97,200	396
1,910	99,118	97,206	396

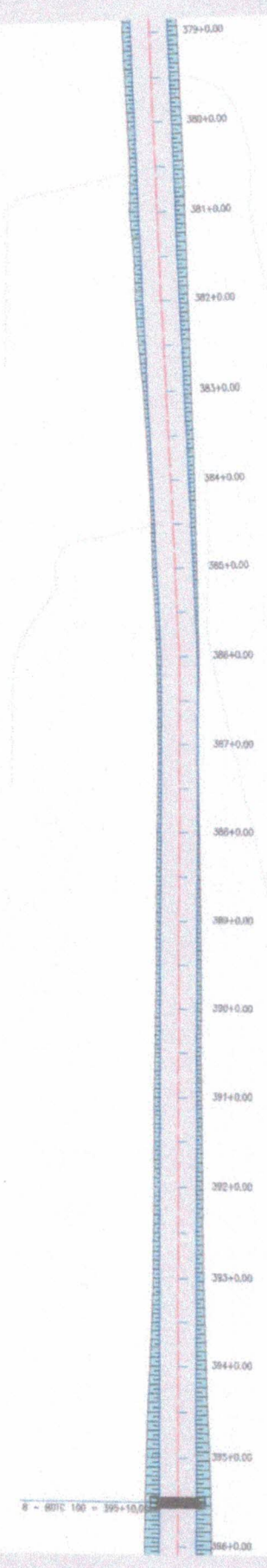

[Handwritten signature]

PROJETO: PAVIMENTAÇÃO ASFALTICA DA ESTRADA QUE LIGA A LOCALIDADE DE ARANAU A LOCALIDADE DE IMBÉ
 ESTAQUEAMENTO E PERFIL LONGITUDINAL
 PREFEITURA MUNICIPAL DE ACARAU
 23 / 27
 ESCALA: 1/1000

PRANCHA - 23

0 1000 2000

Cota vertical	Cota de topografia	Cota de terreno	Cotas
1,910	96,116	97,358	396
1,929	96,154	97,225	396+10,00
1,932	96,202	97,270	397
1,922	96,216	97,327	397+10,00
1,986	96,297	97,402	398
1,947	96,344	97,467	398+10,00
1,967	96,362	97,525	399
1,894	96,438	97,545	399+10,00
1,917	96,488	97,589	400+0
1,930	96,535	97,605	400+10,00
1,928	96,583	97,678	401
1,875	96,632	97,757	401+10,00
1,858	96,680	97,824	402
1,840	96,728	97,888	402+10,00
1,820	96,777	97,957	403
1,737	96,825	98,080	403+10,00
1,835	96,873	98,238	404
1,402	96,922	98,433	404+10,00
1,228	96,970	98,742	405
0,989	100,018	98,928	405+10,00
0,798	100,061	98,383	406
0,868	100,099	98,433	406+10,00
0,633	100,132	98,488	407
0,874	100,181	98,547	407+10,00
0,805	100,188	98,281	408
0,880	100,216	98,611	408+10,00
0,587	100,246	98,680	409
0,621	100,275	98,854	409+10,00
0,661	100,303	98,942	410
0,688	100,332	98,674	410+10,00
0,647	100,360	98,713	411
0,662	100,388	98,757	411+10,00
0,688	100,417	98,729	412
0,713	100,446	98,732	412+10,00
0,724	100,474	98,750	413
0,723	100,494	98,771	413

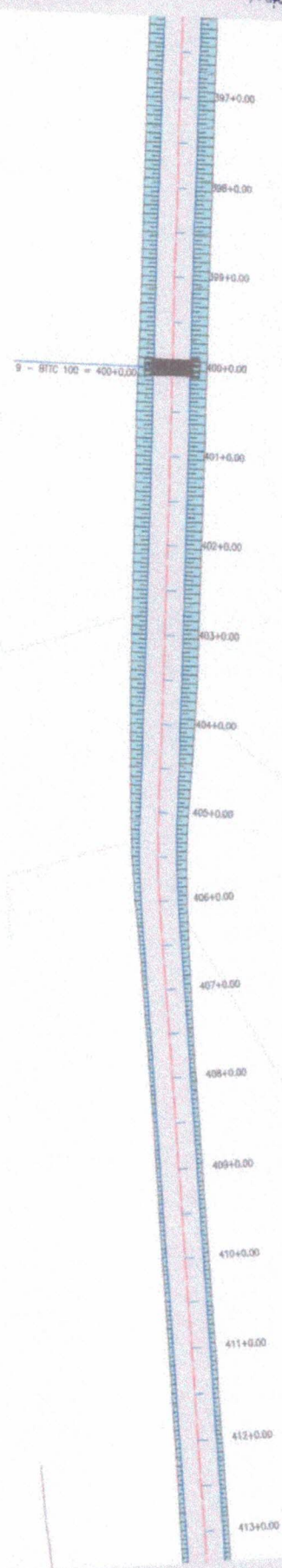
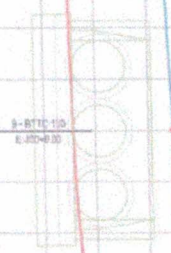

PROJETO: PAVIMENTAÇÃO ASFALTICA DA ESTRADA QUE LIGA A LOCALIDADE DE ARANAU A LOCALIDADE DE IMBÉ

ESTADQUEAMENTO E PERFIL LONGITUDINAL

PROJETADE: M. S. MARTINS, GEOM. S. 1310/00

PRANCHA: 24 / 27

ESCALA: 1/1.000

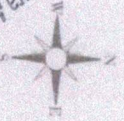

0 - 1000 2000

Data	Cota de	Cota do	Cota do	Elevação
vermelha	terraplenagem	travertino	travertino	
0,723	100,494	98,771	413	
0,722	100,302	98,770	413+10,00	
0,720	100,301	98,811	414	
0,670	100,259	98,889	414+10,00	
0,677	100,268	98,860	415	
0,697	100,636	100,220	415+10,00	
0,596	100,711	100,110	418	
0,388	100,811	100,242	418+10,00	
0,655	100,912	100,387	417	
0,571	101,013	100,442	417+10,00	
0,602	101,133	100,331	418	
0,597	101,243	100,658	418+10,00	
0,590	101,282	100,787	419	
0,571	101,285	101,114	419+10,00	
0,651	101,822	101,271	420	
0,758	101,890	101,132	420+10,00	
0,479	101,786	101,307	421	
0,278	101,682	101,425	421+10,00	
0,187	101,579	101,282	422	
0,255	101,435	101,220	422+10,00	
0,378	101,371	100,885	423	
0,493	101,287	100,778	423+10,00	
0,601	101,182	100,561	424	
0,634	100,298	100,221	424+10,00	
0,660	100,488	99,908	425	
0,623	100,206	99,433	425+10,00	
0,691	99,883	99,602	426	
0,584	99,495	99,501	426+10,00	
0,677	99,457	99,700	427	
0,781	99,448	99,855	427+10,00	
0,739	99,436	99,887	428	
0,667	99,480	99,803	428+10,00	
0,524	99,527	99,244	429	
0,597	99,615	99,618	429+10,00	
0,618	99,692	99,673	430	
0,614	99,770	99,158	430+10,00	
0,613	99,785	99,172	431	

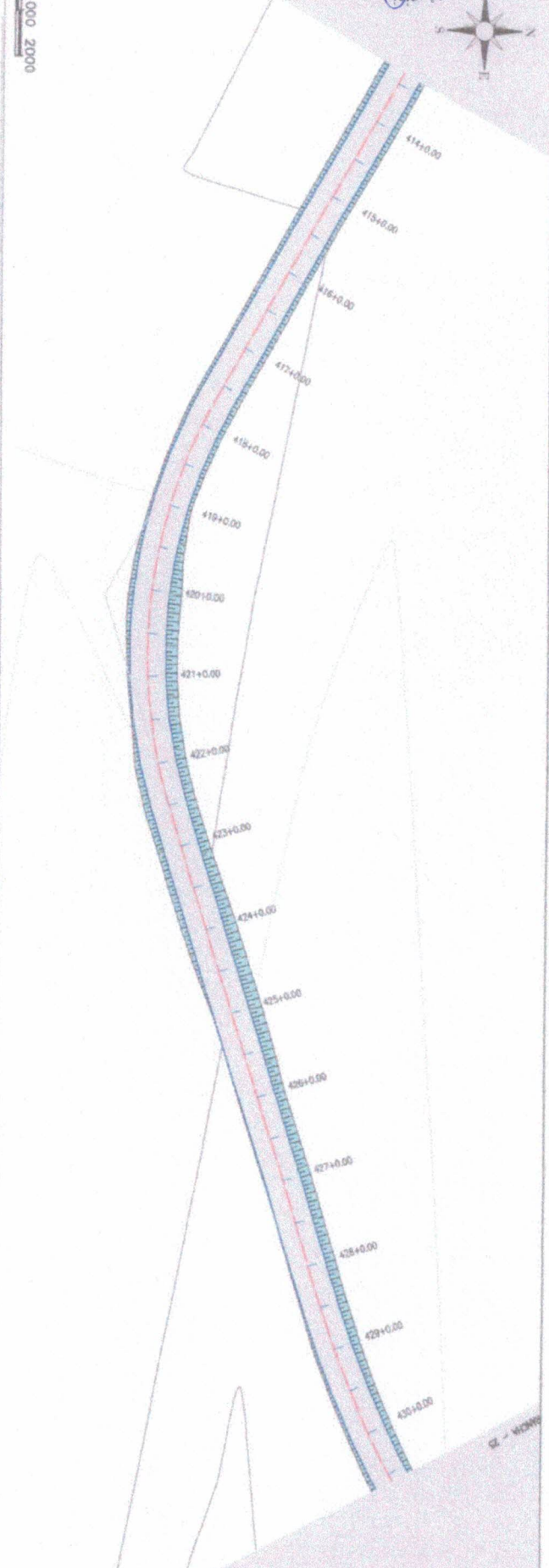
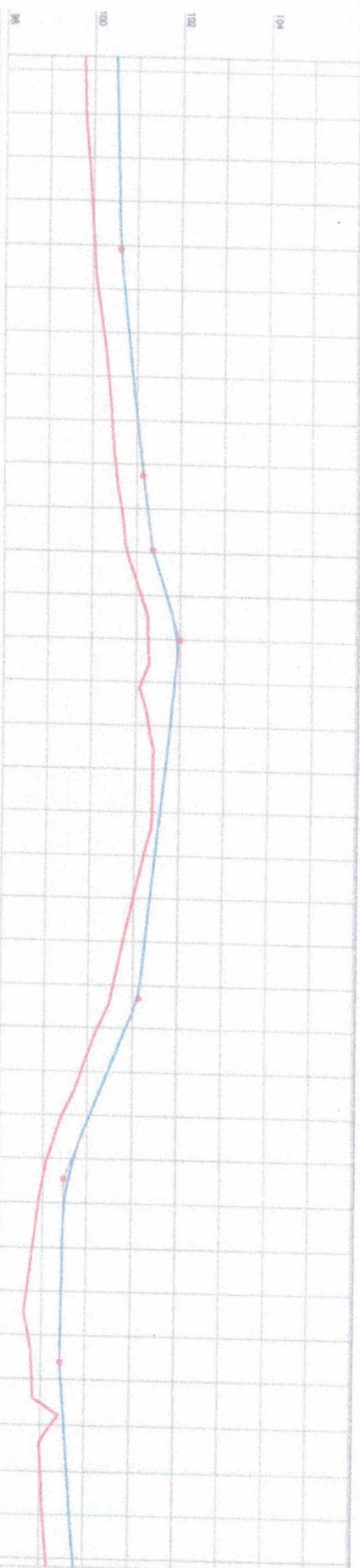

PROJETO
 ANTONIO
 PAULO ALBUQUERQUE DE OLIVEIRA
 PREFEITURA MUNICIPAL DE ARACAJU
 PAVIMENTAÇÃO ASFALTICA DA ESTRADA QUE LIGA A LOCALIDADE DE
 ARACAJU A LOCALIDADE DE IMBÉ
 ESTAQUEAMENTO E PERFIL LONGITUDINAL
 25 / 27
 SCDULA
 1:10000

T

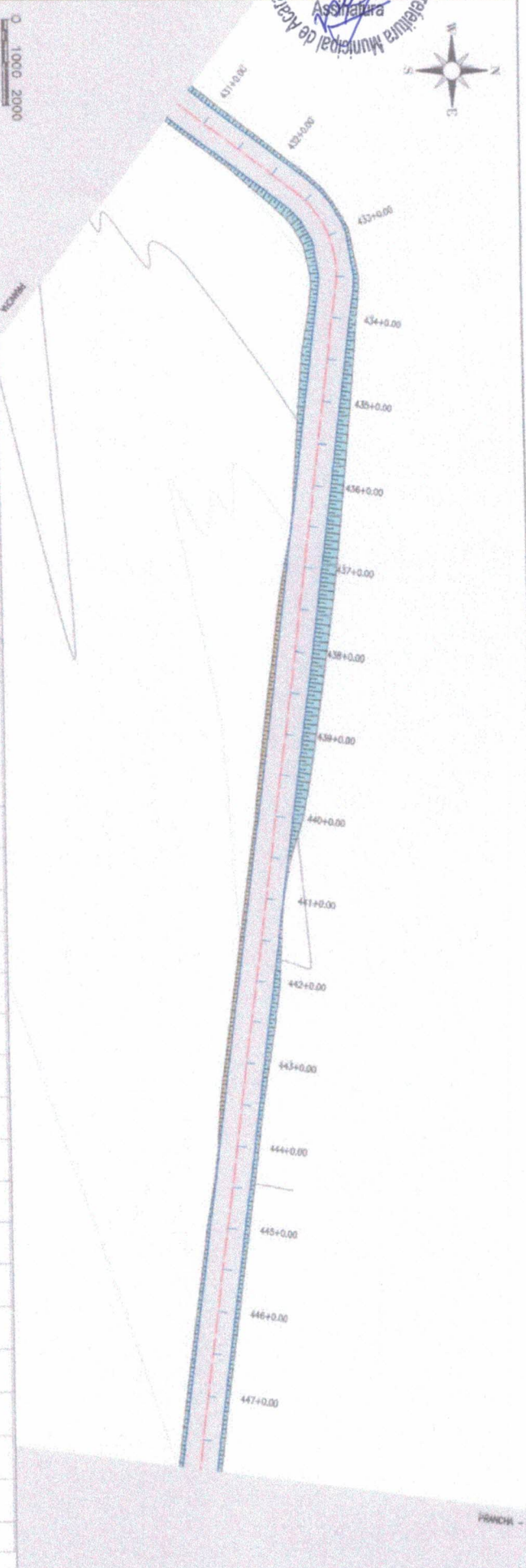

Cota vertical	Cota do topógráfico	Cota do terreno	Estatos
0,813	99,780	99,172	430
0,783	99,847	99,084	431
0,741	99,920	99,184	431+10,00
0,690	100,007	99,607	432
0,590	100,090	99,490	432+10,00
0,492	100,211	99,599	433
0,394	100,340	99,583	433+10,00
0,298	100,488	99,517	434
1,133	100,590	99,483	434+10,00
1,218	100,739	99,448	435
1,303	100,853	99,481	435+10,00
1,110	100,982	99,804	436
0,843	101,110	100,287	436+10,00
0,642	101,231	100,588	437
0,248	101,366	100,347	437+10,00
0,218	101,520	100,240	438
0,234	101,521	100,208	438+10,00
0,812	101,683	100,271	439
0,500	101,848	100,548	439+10,00
0,030	101,997	100,877	440
-0,184	100,806	101,088	440+10,00
0,187	100,941	100,870	441
0,387	100,787	100,370	441+10,00
0,430	100,812	100,232	442
0,883	100,987	100,134	442+10,00
0,548	100,503	99,854	443
0,504	100,478	99,843	443+10,00
0,686	100,516	99,921	444
0,831	100,851	100,020	444+10,00
0,884	100,788	100,132	445
0,548	100,921	100,372	445+10,00
0,602	101,098	100,484	446
0,618	101,191	100,573	446+10,00
0,604	101,209	100,722	447
0,688	101,461	100,872	447+10,00
0,800	101,588	100,896	447

[Handwritten signature]

PROJETO: PAVIMENTAÇÃO ASFALTICA DA ESTRADA QUE LIGA A LOCALIDADE DE ARANAU A LOCALIDADE DE IMBÉ

ARQUEIVO: PAV/AS/AL/316/217/0204/19/016/6

ESTADUEAMENTO E PERFIL LONGITUDINAL

PREFETURA MUNICIPAL DE ACARAU

PRANCHETA: 26 / 27

ESCALA: 1:10000